



BOS AZLINA

**SUPER FAST CREW / UTILITY BOAT
5,800 BHP**

GENERAL DATA

Vessel Name	MV BOS AZLINA
IMO No.	9708019
Call Sign	9MVC2
Year Built	2014
Port Of Registry	Port Kelang
Flag	MALAYSIA
Class	Bureau Veritas
Notation	I, HULL, MACH, Light ship/Fast Utility Boat
Hull Construction	Aluminium Hull- (H110)
Builder	SAM Aluminium Engineering PTE LTD, SINGAPORE
Length Overall (LOA)	40.80 Meter
Beam Moulded	8.0 Meter
Dept Moulded	3.8 Meter
Draft (Max)	1.3 Meter
GRT	298 Tons
NRT	89 Tons
Deadweight	80 Tons

PROPULSION SYSTEM & MANEUVERING

Main Engine	4 x Caterpillar C32, 1,450 BHP @ 2300 RPM
Total HP	5,800 BHP
Main Generator	2 x 86kW @ 1500 RPM Caterpillar C4.4
Gearbox	4 x ZF 3050 (Ratio 2.5 : 1)
Steering Gear	1 x Palmarine PEH 3002-1P
Propeller	4 x Fixed Pitch Propeller
Rudder	2 Rudder
Bow Thruster	1 x PETTER's Electro Hydraulic ; 1 MT

PERFORMANCE

Maximum Speed	32 Knots
Economical Speed	27 Knots @ 85% MCR
Type Of fuel	Marine Gas Oil

DECK CAPACITY

Clear Deck Space	19 m x 6.5 = 123.5 m²
Cargo Capacity	40 MT
Deck Strength	2 MT / m²

TANK CAPACITY

Fuel Oil	80 m³
Fresh Water	20 m³
Lube Oil	700 Liter

PUMP CAPACITY

Fuel Oil Pump	1 x 10 m³ /Hour @ 20m Head
Fresh Water Pump	1 x 3.2 m³ /Hour @ 28m Head
GS Pump/ Bilge Pump	1 x 25 m³ /Hour @ 30m Head
Bilge Pump Emergency	1 x 30 m³ /Hour @ 30m Head
Lube Oil Transfer Pump	0.75 kW / 1 Hp
Submersible Pump	1 x 10 m³ /Hour @ 10m Head

ACCOMMODATION AND MANNING

Passenger Seat/ Accommodation	38 Business Class Seats 3 x 4 Berths
SickBay	50 Pax 1 Room
Accommodation For Crew	10 Berths

DECK EQUIPMENT

Anchor Windlass	1.5 MT @ 5 kW, Electric, Reduction Gear Driven
Anchor (Bow)	2 x 225 Kg
PP Mooring Rope	80mm x 200 Meter
Deck Crane	PK4501 Palfinger, SWL 1 MT @ 5m Radius

NAVIGATION AND COMMUNICATION

Radar	1 x Furuno 1935 MK2- 48 nm 1 x Furuno FR8122 MK3- 72nm
Inmarsat C	1 x Furuno, Felcom 250
EPIRB	1 x McMurdo Model:E5 Smartfind
SART	1 x McMurdo, Model : S4 9Ghz GMDSS
VHF	1 x Furuno FM8800S
GMSS VHF	2 x McMurdo Model : R2
Navtex Receiver	1 x Furuno NX-700B
Walkie Talkie	3 Set Motorola CP200
GYRO Compass	1 x Anschutz Gyro, Model : Standard 2
Magnetic Compass	1 x Daiko Magnetic
GPS	1 x Furuno GPS Navigator, GP-150
SSB	1 x SSB Radiotelephone FS-150
AD Converter	1 x Furuna AD100
Speed Log	1 x Furuno Doppler Speed Log, DS-80
Echo Sounder	1 x Furuno FE-700
Anemometer	1 x RM Young Wind Anemometer
ALS	1 x Furuno ALS Transponder FA-150
Autopilot	Raytheon Autopilot, NP 60

FIRE FIGHTING

<u>EXTERNAL</u>	
FiFi Fire Pump	½ FiFi : 1 x 1,300 m³ /Hour With 2 Fire Monitor
Fire Pump	1 x 25 m³ /Hour @ 30m Head
<u>INTERNAL</u>	
CO ² System	Fixed CO² System In Engine Room
Fire Fighting Equipment	Fully Compliant With SOLAS Requirement
Emergency Fire Pump	1 x 22 m³ /Hour @ 15m Head

LIFE SAVING EQUIPMENT

Life Raft	4 x 65 Men, SOLAS Approved
Life Buoys	8 On Board As Per SOLAS
Life Jacket	99 Pcs
Workboat/Rescue Craft	Inflatable Boat SOLAS Approved With 25 HP Outboard Engine

MISCELLANEOUS

Oily Water Separator	YSF-Q-0.25, 0.37 kW
Sewage Water Treatment	1 x ECOMAR 6 : 2,300 Liter / Day
Oil Dispersant System	1 x Oil Spill Dispersant System
Scrambling Net	2 x (4m x 3m)
Entertainment And PA System	2 Sets Fitted On Board With Flat Screen TV And DVD Player

Note : The information given herein are believed to be correct but not guaranteed. Owner reserve the rights to amend specifications without notification



BAHTERA OFFSHORE (M) SDN BHD (582772-U)

Office IMO No. : 555 1792
NO.39A, JALAN USJ 21/11, 47660 UEP SUBANG JAYA,
SELANGOR DARUL EHSAN, MALAYSIA.
TEL. : +603 8023 8178 , FAX. : +603 8023 8278
Email : bahtera@bahteraoffshore.com.my , WEB : www.bahteraoffshore.com.my

REV : 06/14

BOS AZLINA

PRINCIPAL DIMENSIONS

LENGTH OVERALL	40.80 m
LENGTH WATERLINE	38.60 m
BREADTH MOULDED	8.00 m
DEPTH MOULDED	3.80 m
DESIGN DRAFT (MLD)	1.30 m
FULL LOAD DRAFT (MLD)	1.50 m
PERSONNEL	50
CREW	10

BY I-HULL-MACH LIGHT SHIP/FAST UTILITY VESSEL

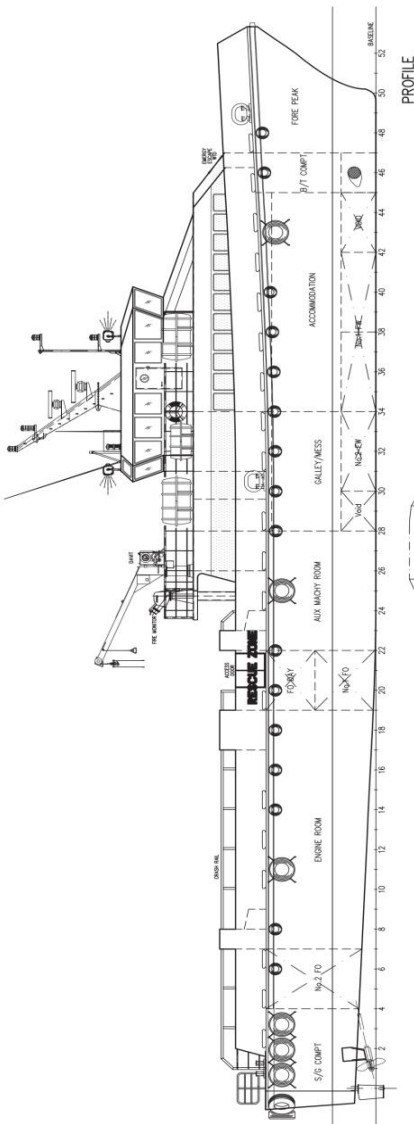

PROFILE

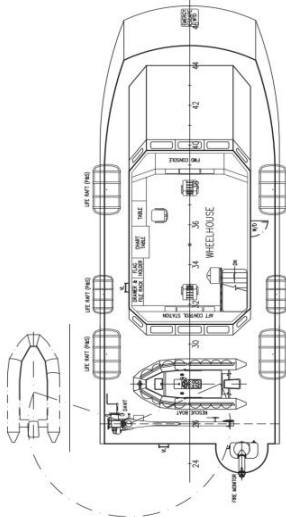

NAV BRIDGE DECK

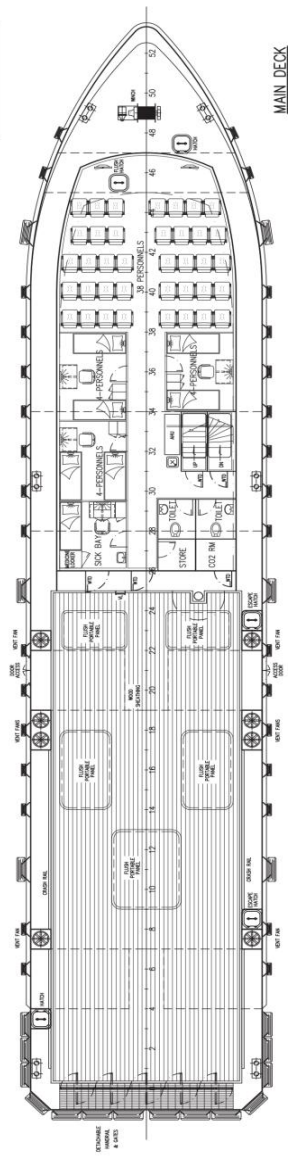

MAIN DECK

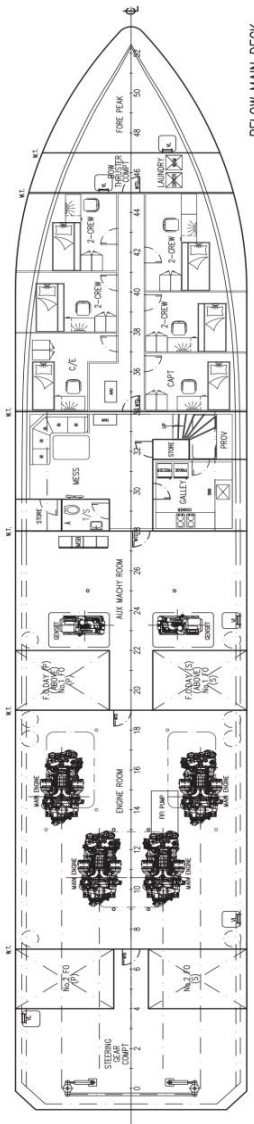

BELOW MAIN DECK

Rev	Alterations	By	Date
20	DOOR (BOW) B BLD 34 DIRECTION CHANGED AS PER FITTED	JT	11/08/14
19	REMOVED AS PER OWNER'S REQUEST. PERSONNEL CABIN AND UPBOARD	JT	14/08/14
18	REMOVED AS PER OWNER'S REQUEST. PERSONNEL CABIN AND UPBOARD	JT	06/08/14
17	REMOVED AS PER FITTED	JT	18/08/14
16	REMOVED AS PER FITTED	JT	09/05/14
15	REMOVED AS PER YARD COMMENTS	JT	24/03/14
14	REMOVED AS PER YARD COMMENTS	JT	11/03/14
13	STRUCTURE 300 BELOW MAIN DECK REMOVED AS PER YARD'S COMMENT	JT	27/01/14
12	REMOVED AS PER YARD COMMENTS	JT	12/11/13
11	REMOVED AS PER YARD COMMENTS	JT	11/11/13
10	REMOVED AS PER YARD COMMENTS	JT	08/11/13
9	REMOVED AS PER YARD COMMENTS	JT	29/10/13
8	TANKS ARRANGEMENT CHANGED	JT	09/10/13
7	DEPTH MOULDED INCREASED TO 3.8m	JT	03/10/13
6	REMOVED AS PER YARD'S COMMENT	JT	13/09/13
5	ENGINE ROOM SHIFTED 1 FRAME TNG RE-ARRANGED TANKS & ACCOM.	JT	05/09/13
4	REMOVED AS PER YARD'S COMMENT	JT	23/08/13
3	REMOVED TANK (BOW POB-23), ADDED FOLDAY 'K'	JT	10/07/13

SAM ALUMINIUM ENGINEERING & CONSTRUCTION PTE LTD
 27-A, Juring Port Road
 Singapore 619101
 Tel: 6366 8840 Fax: 6366 3083 E-mail: sam@sam-engineering.com

BUREAU VERITAS
 40m FAST CREW BOAT
 GENERAL ARRANGEMENT

Project: 40m FAST CREW BOAT
 Drawing No: 40m FAST CREW BOAT
 Date: 12/12/12
 Scale: 1:20
 Sheet: 1 of 1

Approved By :
 On :

Note : The information given herein are believed to be correct but not guaranteed. Owner reserve the rights to amend specifications without notification



BAHTERA OFFSHORE (M) SDN BHD (582772-U)
 Office IMO No. : 555 1792
 NO.39A, JALAN USJ 21/11, 47660 UEP SUBANG JAYA,
 SELANGOR DARUL EHSAN, MALAYSIA.
 TEL. : +603 8023 8178, FAX. : +603 8023 8278
 Email : bahtera@bahteraoffshore.com.my, WEB : www.bahteraoffshore.com.my